

## TD93-..NPT-BO

### M-NPT x M-MET-24

RECHTE INSCHROEFKOPPELING

UNION SIMPLE MÂLE

MALE STUD COUPLING

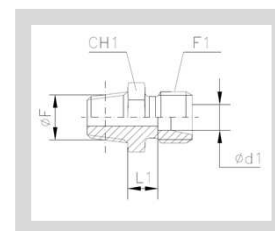

Serie Série Series	Ød1	PN	L1	F1	ØF	CH1		
LL	4	100	8	M8x1	1/8"	11	TD93-4LLNPT-BO	
	5		6,5	M10x1	1/8"	11	TD93-5LLNPT-BO	
	6		6,5	M10x1	1/8"	11	TD93-6LLNPT-BO	
	8		6,5	M12x1	1/8"	12	TD93-8LLNPT-BO	
L	6	315	7	M12x1.5	1/8"	12	TD93-6LNPT-BO	
	6		8	M12x1.5	1/4"	17	TD93-6LNPT1/4-BO	
	8		8	M14x1.5	1/4"	17	TD93-8LNPT-BO	
	8		9	M14x1.5	3/8"	19	TD93-8LNPT3/8-BO	
	10		9	M16x1.5	1/4"	17	TD93-10LNPT-BO	
	10		10	M16x1.5	3/8"	19	TD93-10LNPT3/8-BO	
	10		10	M16x1.5	1/2"	22	TD93-10LNPT1/2-BO	
	12		10	M18x1.5	1/4"	19	TD93-12LNPT1/4-BO	
	12		10	M18x1.5	3/8"	19	TD93-12LNPT-BO	
	12		10	M18x1.5	1/2"	22	TD93-12LNPT1/2-BO	
	15		11	M22x1.5	3/8"	24	TD93-15LNPT3/8-BO	
	15		11	M22x1.5	1/2"	24	TD93-15LNPT-BO	
	18		11,5	M26x1.5	1/2"	27	TD93-18LNPT-BO	
	18		160	11,5	M26x1.5	3/4"	32	TD93-18LNPT3/4-BO
	22			13,5	M30x2	3/4"	32	TD93-22LNPT-BO
	28			14,5	M36x2	1"	41	TD93-28LNPT-BO
	35			14,5	M45x2	1 1/4"	46	TD93-35LNPT-BO
	42			16	M52x2	1 1/2"	55	TD93-42LNPT-BO
6	630	12		M14x1.5	1/4"	17	TD93-6SNPT-BO	
8		13	M16x1.5	1/4"	17	TD93-8SNPT-BO		
10		12,5	M18x1.5	1/4"	19	TD93-10SNPT1/4-BO		
10		12,5	M18x1.5	3/8"	19	TD93-10SNPT-BO		
12		14,5	M20x1.5	1/4"	22	TD93-12SNPT1/4-BO		
12		14,5	M20x1.5	3/8"	22	TD93-12SNPT-BO		
12		14,5	M20x1.5	1/2"	22	TD93-12SNPT1/2-BO		
14		16	M22x1.5	1/2"	24	TD93-14SNPT-BO		
16		400	17,5	M24x1.5	1/2"	27	TD93-16SNPT-BO	
20			17,5	M30x2	3/4"	32	TD93-20SNPT-BO	
25			18	M36x2	1"	41	TD93-25SNPT-BO	
30			19,5	M42x2	1.1/4"	46	TD93-30SNPT-BO	
38	315		22	M52x5	1.1/2"	55	TD93-38SNPT-BO	

## TD94-..NPT-BO

### M-NPT x M-MET-24

MANNELIJKE ELLEBOOG  
COUDE MÂLE  
MALE STUD ELBOW

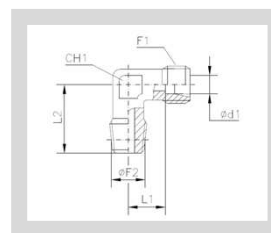

Serie Série Series	d1	PN	L1	L2	F1	F2	CH1	
LL	4	100	11	17	M8x1	1/8"	9	TD94-4LLNPT-BO
	5		9,5	17	M10x1	1/8"	9	TD94-5LLNPT-BO
	6		9,5	17	M10x1	1/8"	9	TD94-6LLNPT-BO
	8		11,5	20	M12x1	1/8"	12	TD94-8LLNPT-BO
L	6	315	12	20	M12x1.5	1/8"	12	TD94-6LNPT-BO
	6		14	26	M12x1.5	1/4"	12	TD94-6LNPT1/4-BO
	8		14	26	M14x1.5	1/4"	12	TD94-8LNPT-BO
	8		17	28	M14x1.5	3/8"	17	TD94-8LNPT3/8-BO
	10		15	27	M16x1.5	1/4"	14	TD94-10LNPT-BO
	10		17	28	M16x1.5	3/8"	17	TD94-10LNPT3/8-BO
	12		17	28	M18x1.5	1/4"	17	TD94-12LNPT1/4-BO
	12		17	28	M18x1.5	3/8"	17	TD94-12LNPT-BO
	12		21	34	M18x1.5	1/2"	19	TD94-12LNPT1/2-BO
	15		21	34	M22x1.5	1/2"	19	TD94-15LNPT-BO
	18		23,5	36	M26x1.5	1/2"	24	TD94-18LNPT-BO
	22	160	27,5	42	M30x2	3/4"	27	TD94-22LNPT-BO
	28		30,5	48	M36x2	1"	36	TD94-28LNPT-BO
	35		34,5	54	M45x2	1 1/4"	41	TD94-35LNPT-BO
42		40	61	M52x2	1 1/2"	50	TD94-42LNPT-BO	
S	6	630	16	26	M14x1.5	1/4"	12	TD94-6SNPT-BO
	8		17	27	M16x1.5	1/4"	14	TD94-8SNPT-BO
	10		17,8	28	M18x1.5	3/8"	17	TD94-10SNPT-BO
	12		21,5	31	M20x1.5	3/8"	17	TD94-12SNPT-BO
	12		22,5	32	M20x1.5	1/2"	19	TD94-12SNPT1/2-BO
	14		22	34	M22x1.5	1/2"	19	TD94-14SNPT-BO
	16	400	24,5	36	M24x1.5	1/2"	24	TD94-16SNPT-BO
	20		26,5	42	M30x2	3/4"	27	TD94-20SNPT-BO
	25		30	48	M36x2	1"	36	TD94-25SNPT-BO
	30		35,5	54	M42x2	1.1/4"	41	TD94-30SNPT-BO
38	315	41	61	M52x2	1.1/2"	50	TD94-38SNPT-BO	

## TD192-..NPT

### M-NPT

INBUS PLUG  
BOUCHON À HEXAGONE  
INNER HEXAGON PLUG

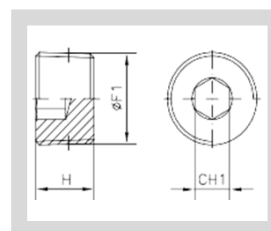

H	CH1	F1	
7,9	5/32"	1/16"	TD192-1/16NPT
7,9	3/16"	1/8"	TD192-1/8NPT
11,1	1/4"	1/4"	TD192-1/4NPT
12,7	5/16"	3/8"	TD192-3/8NPT
14,3	3/8"	1/2"	TD192-1/2NPT
15,9	9/16"	3/4"	TD192-3/4NPT
19	5/8"	1"	TD192-1NPT
20,6	3/4"	1 1/4"	TD192-1 1/4NPT
20,6	1"	1 1/2"	TD192-1 1/2NPT

## TD96-..NPT-BO

M-MET-24 x M-MET-24 x M-NPT

MANNELIJKE T-STUK  
TE MÂLE  
STUD BRANCH TEE

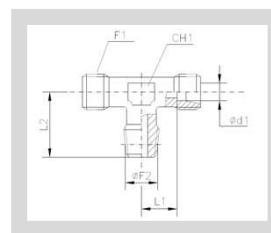

Serie Série Series	Ød1	PN	L1	L2	F1	ØF2	CH1		
LL	4	100	11	17	M8x1	1/8"	9	TD96-4LLNPT-BO	
	5		9,5	17	M10x1	1/8"	9	TD96-5LLNPT-BO	
	6		9,5	17	M10x1	1/8"	9	TD96-6LLNPT-BO	
	8		11,5	20	M12x1	1/8"	12	TD96-8LLNPT-BO	
L	6	315	12	20	M12x1.5	1/8"	12	TD96-6LNPT-BO	
	8		14	26	M14x1.5	1/4"	12	TD96-8LNPT-BO	
	10		15	27	M16x1.5	1/4"	14	TD96-10LNPT-BO	
	12		17	28	M18x1.5	3/8"	17	TD96-12LNPT-BO	
	15		21	34	M22x1.5	1/2"	19	TD96-15LNPT-BO	
	18	23,5	36	M26x1.5	1/2"	24	TD96-18LNPT-BO		
	22	160	27,5	42	M30x2	3/4"	27	TD96-22LNPT-BO	
	28		30,5	48	M36x2	1"	36	TD96-28LNPT-BO	
	35		34,5	54	M45x2	1.1/4"	41	TD96-35LNPT-BO	
	42		40	61	M52x2	1.1/2"	50	TD96-42LNPT-BO	
S	6		630	16	26	M14x1.5	1/4"	12	TD96-6SNPT-BO
8	17	27		M16x1.5	1/4"	14	TD96-8SNPT-BO		
10	17,5	28		M18x1.5	3/8"	17	TD96-10SNPT-BO		
12	21,5	31		M20x1.5	3/8"	17	TD96-12SNPT-BO		
14	22	34		M22x1.5	1/2"	19	TD96-14SNPT-BO		
S	16	400	24,5	36	M24x1.5	1/2"	24	TD96-16SNPT-BO	
	20		26,5	42	M30x2	3/4"	27	TD96-20SNPT-BO	
	25		30	48	M36x2	1"	36	TD96-25SNPT-BO	
	30		35,5	54	M42x2	1.1/4"	41	TD96-30SNPT-BO	
	38		315	41	61	M52x2	1.1/2"	50	TD96-38SNPT-BO

## TD127-..NPT-BO

M-NPT x M-MET-24 x M-MET-24

MANNELIJK T-STUK  
TE MÂLE  
STUD BRANCH TEE

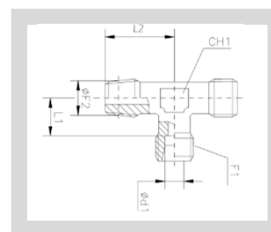

Serie Série Series	Ød1	PN	L1	L2	F1	ØF2	CH1		
LL	4	100	11	17	M8x1	1/8"	9	TD127-4LLNPT-BO	
	5		9,5	17	M10x1	1/8"	9	TD127-5LLNPT-BO	
	6		9,5	17	M10x1	1/8"	9	TD127-6LLNPT-BO	
	8		11,5	20	M12x1	1/8"	12	TD127-8LLNPT-BO	
L	6	315	12	20	M12x1.5	1/8"	12	TD127-6LNPT-BO	
	8		14	26	M14x1.5	1/4"	12	TD127-8LNPT-BO	
	10		15	27	M16x1.5	1/4"	14	TD127-10LNPT-BO	
	12		17	28	M18x1.5	3/8"	17	TD127-12LNPT-BO	
	15		21	34	M22x1.5	1/2"	19	TD127-15LNPT-BO	
	18	23,5	36	M26x1.5	1/2"	24	TD127-18LNPT-BO		
	22	160	27,5	42	M30x2	3/4"	27	TD127-22LNPT-BO	
	28		30,5	48	M36x2	1"	36	TD127-28LNPT-BO	
	35		34,5	54	M45x2	1.1/4"	41	TD127-35LNPT-BO	
	42		40	61	M52x2	1.1/2"	50	TD127-42LNPT-BO	
S	6		630	16	26	M14x1.5	1/4"	12	TD127-6SNPT-BO
8	17	27		M16x1.5	1/4"	14	TD127-8SNPT-BO		
10	17,5	28		M18x1.5	3/8"	17	TD127-10SNPT-BO		
12	21,5	31		M20x1.5	3/8"	17	TD127-12SNPT-BO		
14	22	34		M22x1.5	1/2"	19	TD127-14SNPT-BO		
S	16	400	24,5	36	M24x1.5	1/2"	24	TD127-16SNPT-BO	
	20		26,5	42	M30x2	3/4"	27	TD127-20SNPT-BO	
	25		30	48	M36x2	1"	36	TD127-25SNPT-BO	
	30		35,5	54	M42x2	1.1/4"	41	TD127-30SNPT-BO	
	38		315	41	61	M52x2	1.1/2"	50	TD127-38SNPT-BO